

# Installation Overview

- 3** HALFWAY PEEL BACK THE LINING FROM THE UNDERSIDE OF THE AQUA TILE, SO THAT PIPE IS GIVEN ACCESS TO THE RUBBER BOOT

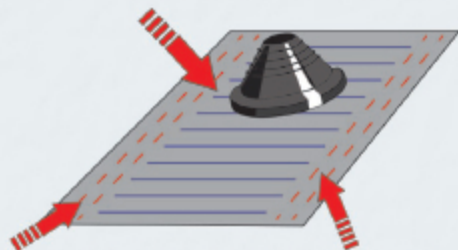

FULL BUTYL ADHESIVE ON THE UNDERSIDE OF FLASHING

- 2** CUT THE RUBBER CONE AT LEAST 15mm SMALLER THAN PIPE O.D. WITH A SHARP KNIFE OR SCISSORS

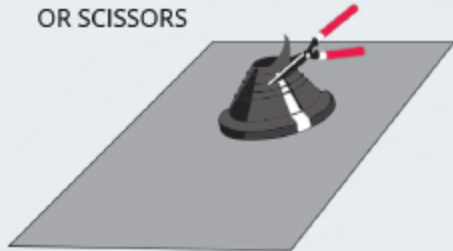

- 1** ENSURE TILES ARE CLEANED BEFORE INSTALLING THE AQUA TILE FLASHING TO ENSURE THE BUTYL ADHESIVE CAN HAVE MAXIMUM EFFECT WHEN BONDED TO THE TILES

- 4** LUBRICATE PIPE WITH WATER AND SLIDE THE FLASHING DOWN THE PIPE

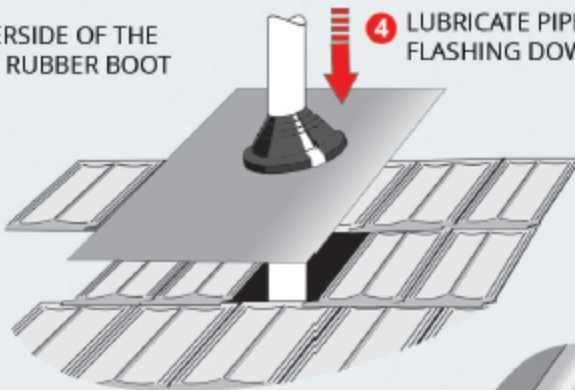

- 5** FORM AN ANTI-CAPILLARY FOLD AT TOP OF BASE SHEET

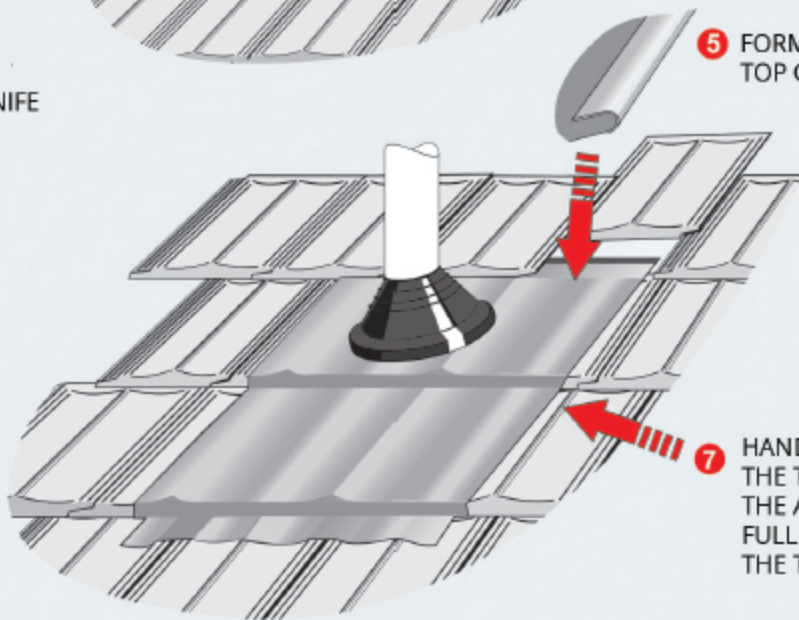

- 6** REMOVE THE REMAINING PROTECTIVE BACKING FROM THE UNDERSIDE OF THE AQUA TILE THAT IS COVERING THE BUTYL ADHESIVE

- 7** HAND FORM THE BASE ALL AROUND THE TILE AND APPLY PRESSURE TO THE AQUA TILE BASE, SO THAT THE FULL BUTYL ADHESIVE STICKS TO THE TILES